

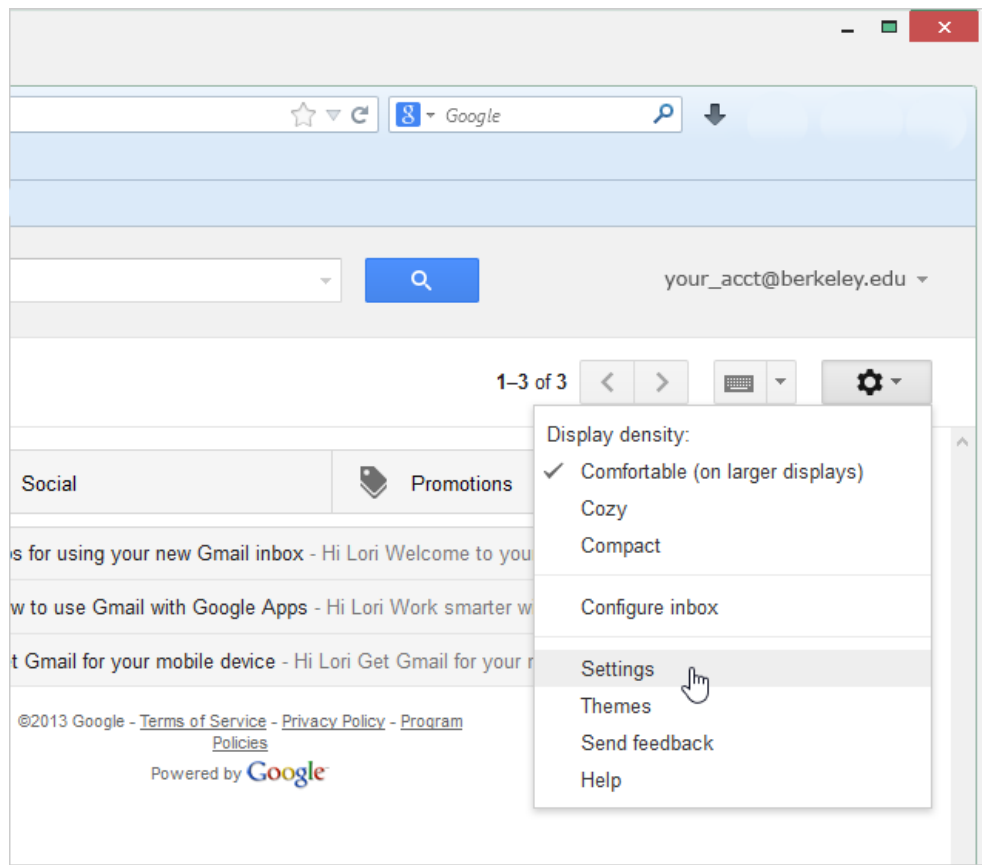

How do I Enable IMAP?

This is the first step to configuring bMail on an email client like Outlook. Enabling IMAP allows email clients to link and access your emails properly.

Step	Procedure
1	Go to your bMail . Click on the Gear icon in the upper right hand corner and select Settings .



Step	Procedure
------	-----------

2	In Settings, go to the Forwarding and POP/IMAP tab.
---	--

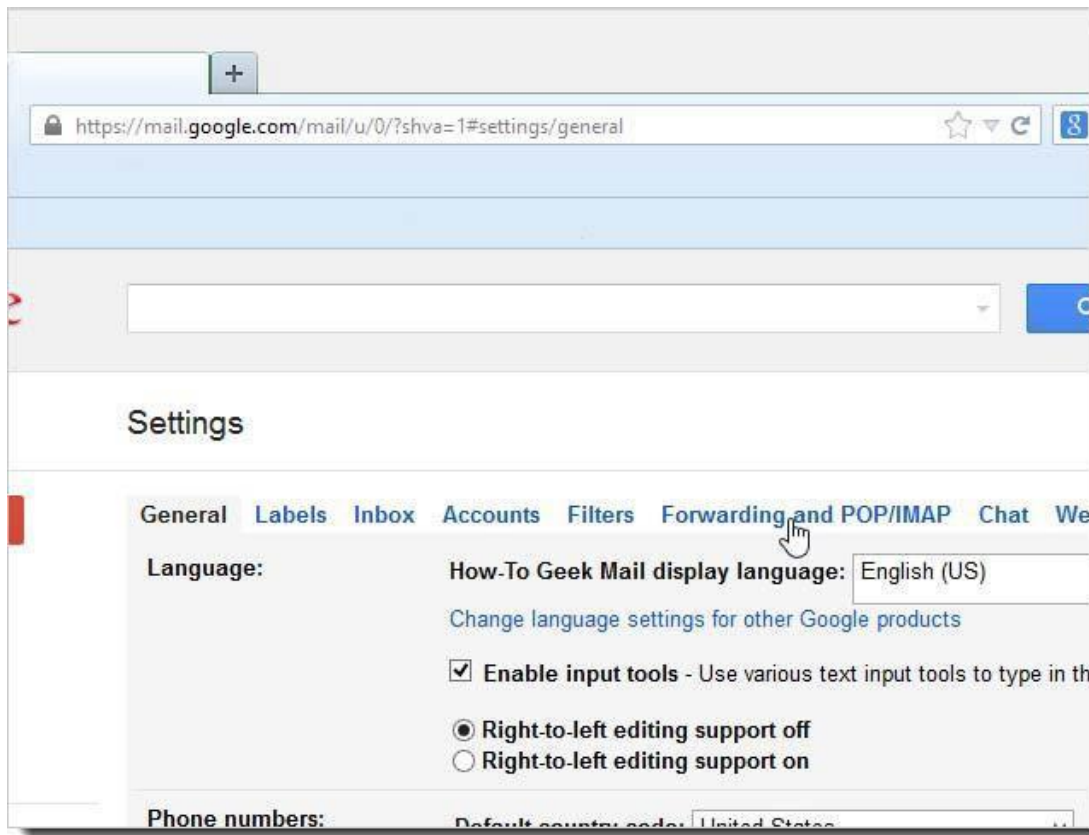

Step	Procedure
------	-----------

3	In the IMAP Access: section, click the Enable IMAP radio button.
---	--

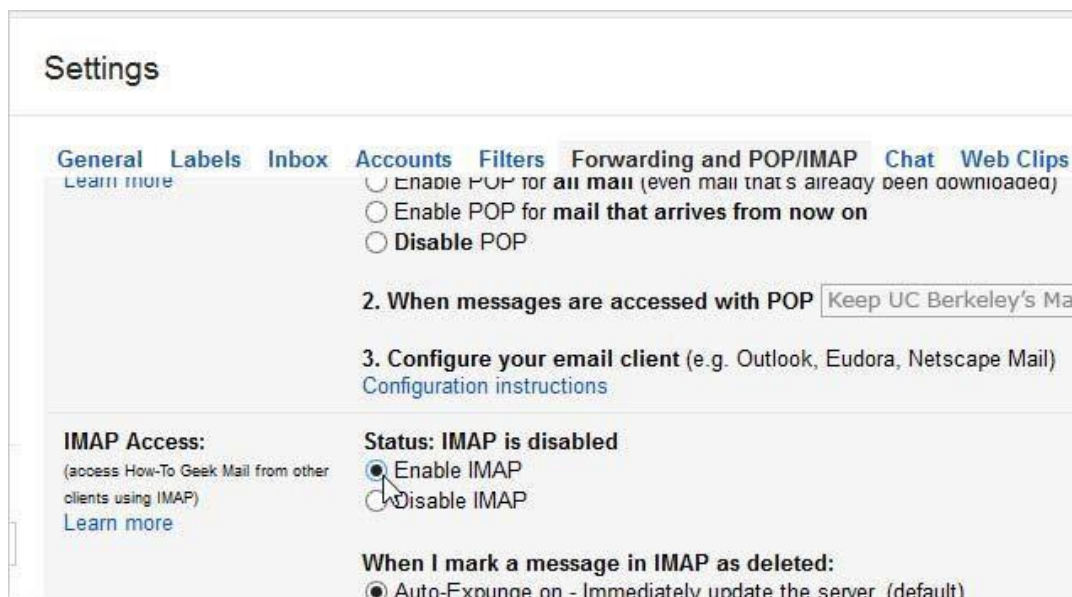

Step	Procedure
4	Go to the bottom of the page and click Save Changes .

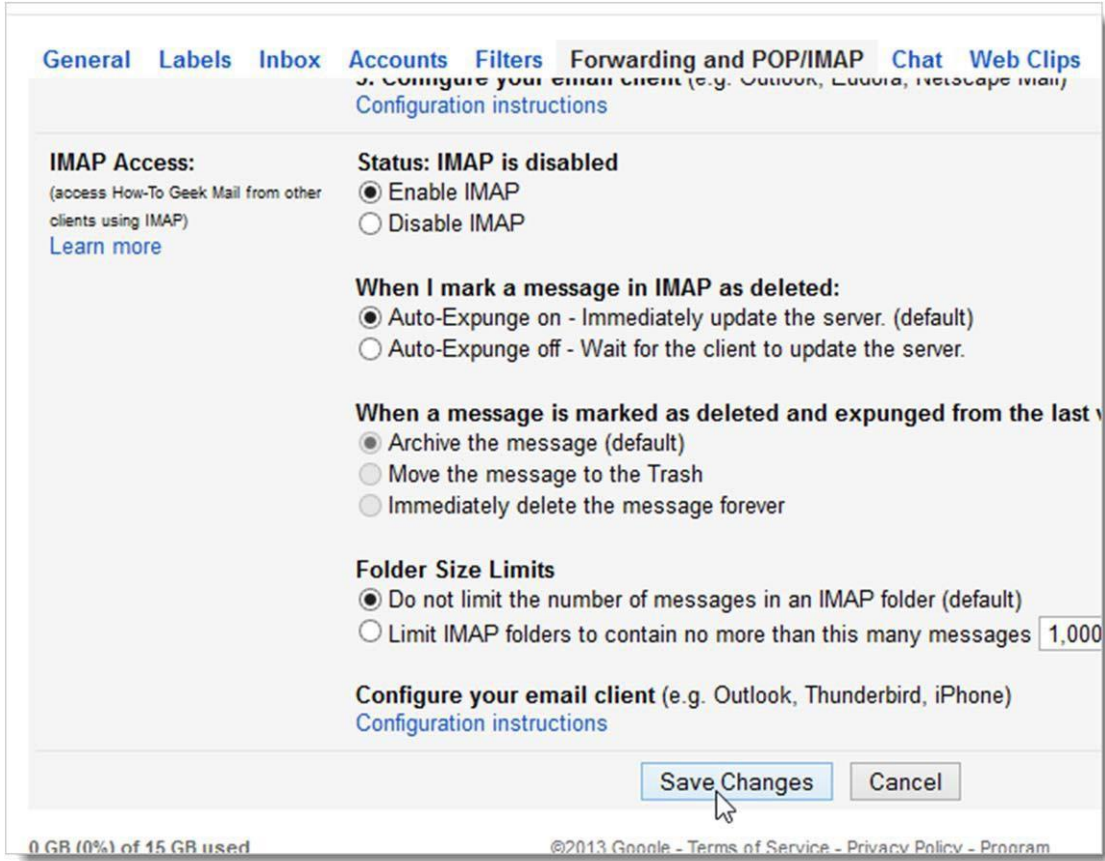

That's it! IMAP is now enabled.